

1		2		3		4	
D	C	B	A	版本 Rev No.	描述 Description	日期 Date	姓名 Name

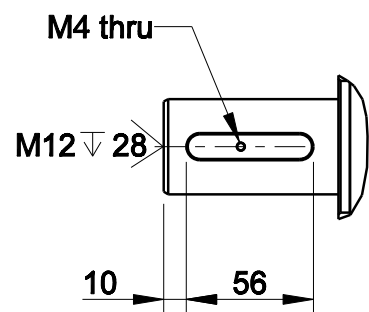

Option "K" : full key 12 x 8 x 56

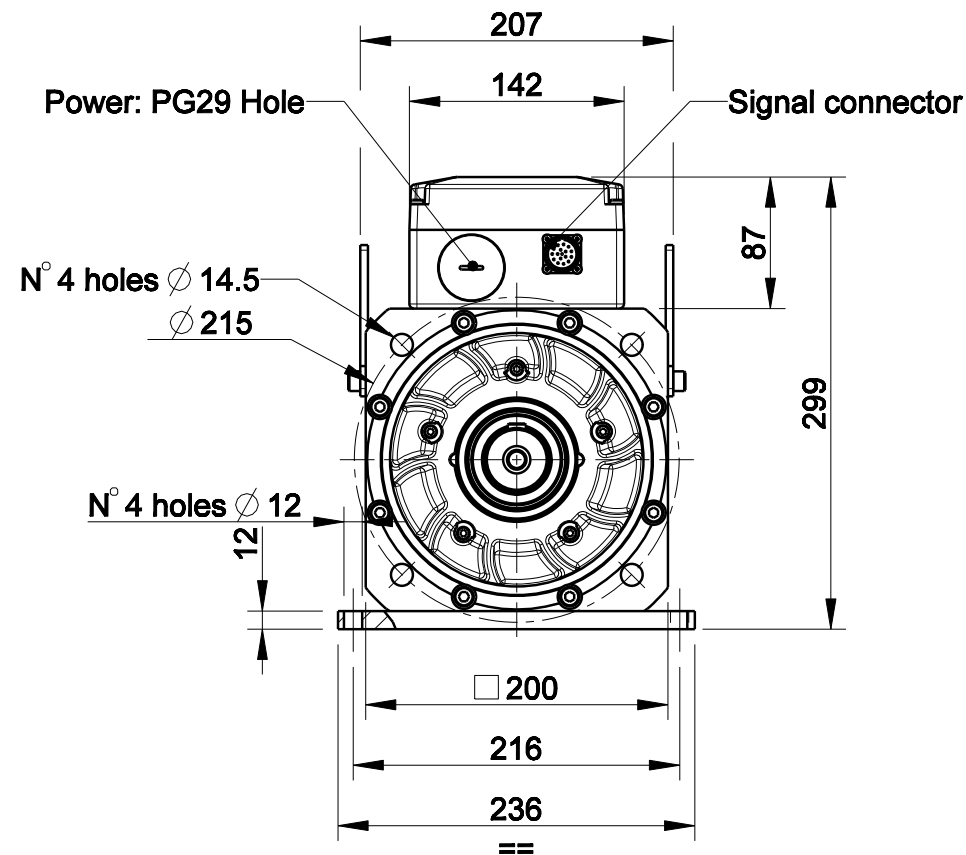
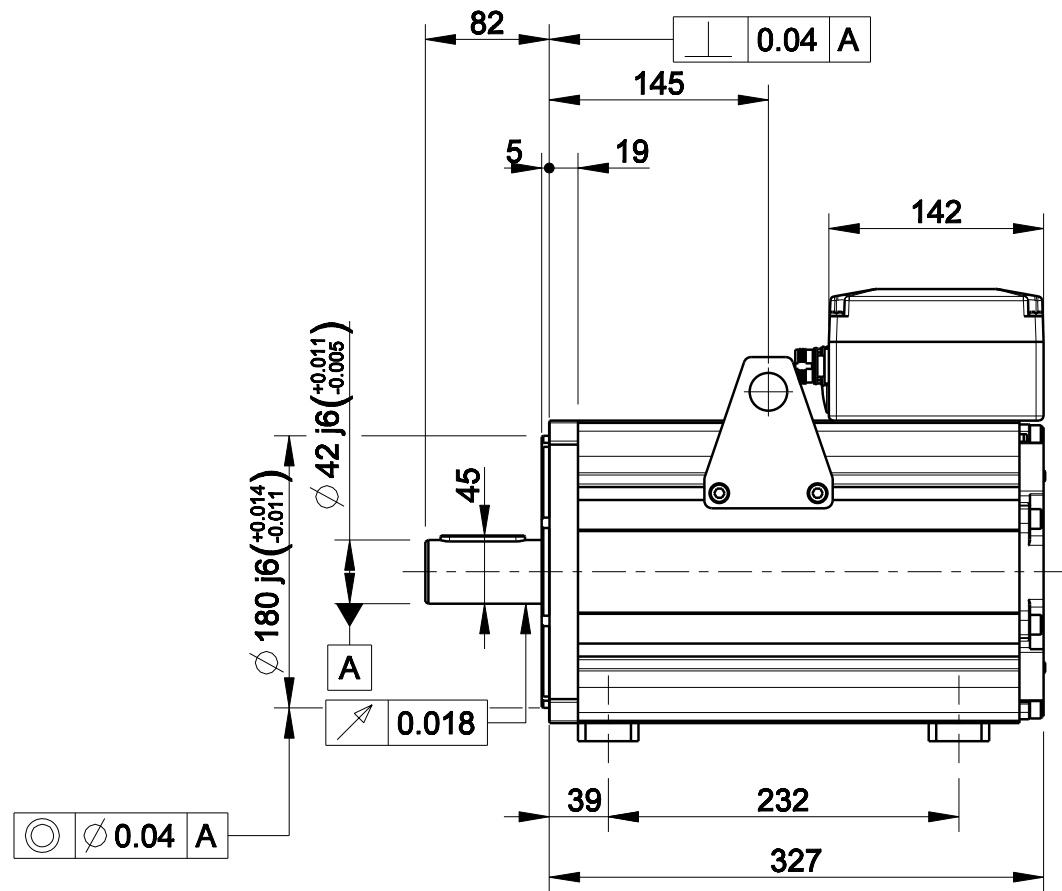
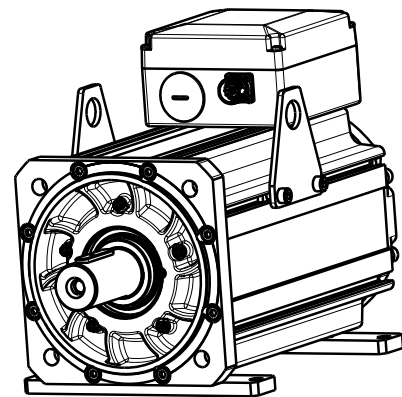

Approved	
Signature	Date

Pin	EnDat Code:C,M,N,U,Q	Resolver Code:R	SinCos Code:S
1	A+	n.c.	A+
2	A-	n.c.	A-
3	DATA+	n.c.	I+(Index)
4	PTC+	SIN-, 1 c/r	Sin-(C-), 1 c/r
5	CLOCK+	COS-, 1 c/r	Cos-(D-), 1 c/r
6	n.c.	COS-, 1 c/r	Cos-(D+), 1 c/r
7	0 V	RESEX+	0 V
8	KTY84+**	KTY84+**	PTC+
9	KTY84-**	KTY84-**	PTC-/KTY-**
10	+Vcc	RESEX-	+Vcc(5Vdc)
11	B+	n.c.	B+
12	B-	n.c.	B-
13	DATA-	n.c.	I-(Index)
14	CLOCK-	SIN+, 1 c/r	Sin+(C+), 1 c/r
15	0V sense	n.c.	0V sense
16	Vcc sense	PTC+	+Vcc sense
17	PTC-	PTC-	KTY+**



Signal Connector
Type: M23 Size 1-17 Pin

材质 Material	处理 Treatment	几何公差 GB/T1184 (ISO 2768-2) Geometrical tolerance	K	未注倒角 Undimensioned chamfers	1x45°	项目 Project-Prod.item/Instrument	U31007A203
未注公差 GB/T1804 (ISO 2768-2) Linear tolerance	m	角度公差 GB/T1804 (ISO 2768-1) Angular tolerance	±1°	未注圆角 Undimensioned radii	R0,5	描述 Description	MOTOR ASSEMBLY
0.5 +3	>3+ 6	>6+ 30	>30+ 120	>120 +400	>400+ 1000	>1000 +2000	>2000 +4000
±0.1	±0.1	±0.2	±0.3	±0.5	±0.8	±1.2	±2
设计 Designed	年,月,日 Date	名字 Name	PHASE MOTION CONTROL	图号 Drawing No.	50221N-1-A-3	版本 Rev	A
绘图 Drawn			重量 Kg Mass	48.761	数量 Qty	1/1	页码 Sheet
校对 Checked							