

1		2		3		4	
版本 Rev No.		描述 Description		日期 Date		姓名 Name	

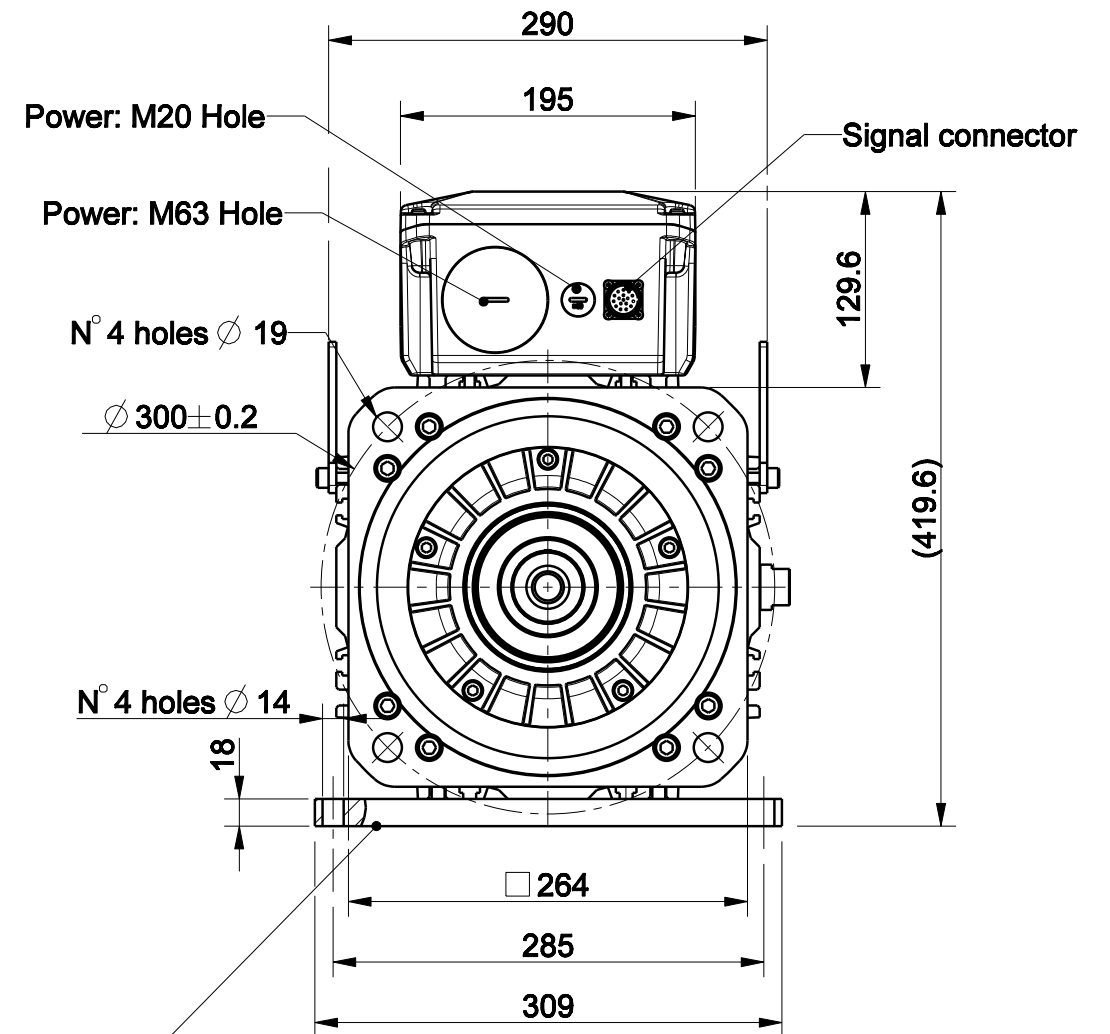

Option "U" : baseplate

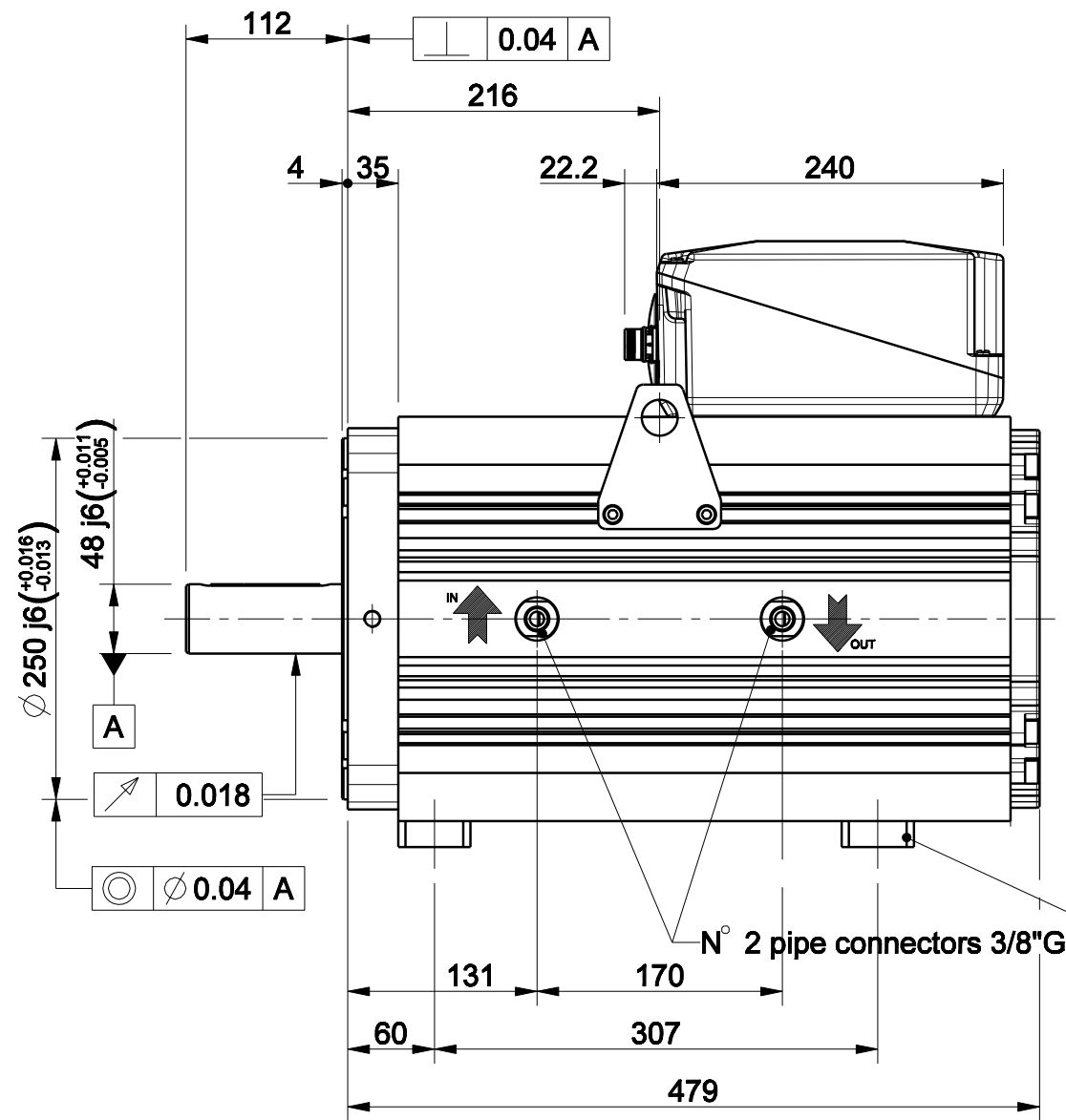
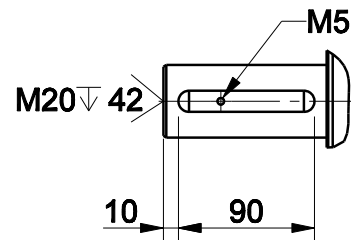

Option "K" : full key 14 x 9 x 90

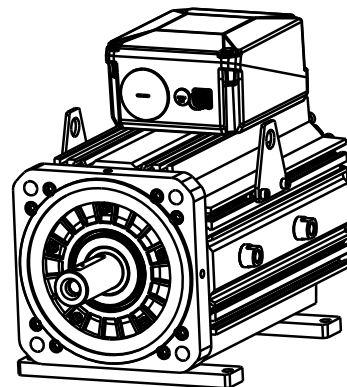

Approved	
Signature	Date

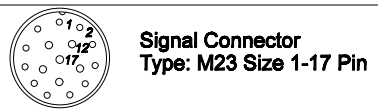

Pin	EnDet Code: C, M, N, U, Q	Receiver Code: R	SnCode: S
1	A+	n.c.	A+
2	A-	n.c.	A-
3	DATA+	n.c.	I-(index)
4	PTC+	SIN+, 1 c/r	Sin-(C-), 1 c/r
5	CLOCK+	COS+, 1 c/r	Cos+(D-), 1 c/r
6	n.c.	COS-, 1 c/r	Cos-(D+), 1 c/r
7	0 V	RESEX+	0 V
8	KTY84+ ^{***}	KTY84+ ^{***}	PTC+
9	KTY84- ^{***}	KTY84- ^{***}	PTC-KTY- ^{***}
10	+Vcc	RESEX-	+Vcc(5Vdc)
11	B+	n.c.	B+
12	B-	n.c.	B-
13	DATA-	n.c.	I-(index)
14	CLOCK-	SIN-, 1 c/r	Sin+(C+), 1 c/r
15	0V sense	n.c.	0V sense
16	Vcc sense	PTC+	+Vcc sense
17	PTC-	PTC-	KTY+ ^{***}

材质 Material				项目 Project-Prod.item/Instrument			
处理 Treatment				U31320C203			
几何公差 GB/T1184 (ISO 2768-2) Geometrical tolerance		K		未注倒角 Undimensioned chamfers	1x45°		
未注公差 GB/T1804 (ISO 2768-1) Linear tolerance		m					
角度公差 GB/T1804 (ISO 2768-1) Angular tolerance		m		未注圆角 Undimensioned radii	R0,5		
0.5 +3	>3+ 6	>6+ 30	>30+ 120			>120 +400	>400+ 1000
±0.1	±0.1	±0.2	±0.3	±0.5	±0.8	±1.2	±2
年,月,日 Date		名字 Name		图号 Drawing No.		版本 Rev	A
设计 Designed		PMC		67983N-2-A-3		比例 Scale	1:5
校对 Checked				重量 Kg		数量 Qty	页码 Sheet
审核 Approved				127.878 Mass			1/1



宁波菲仕运动控制技术有限公司
NINGBO PHASE MOTION CONTROL CO.,LTD.