

Type	D (mm)	A (mm)
1004x	156	254
1007x	231	328
1010x	306	404
1013x	380	478

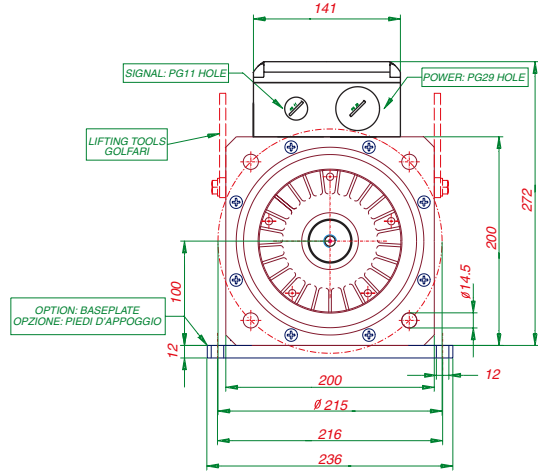

Curve delle prestazioni

Safe operating areas

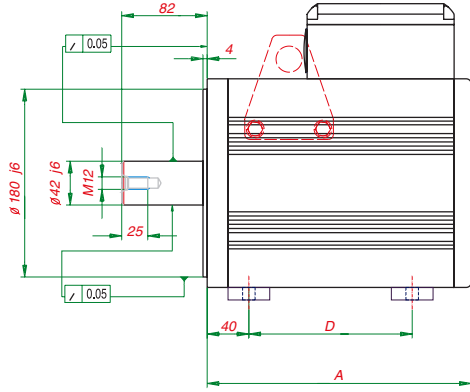
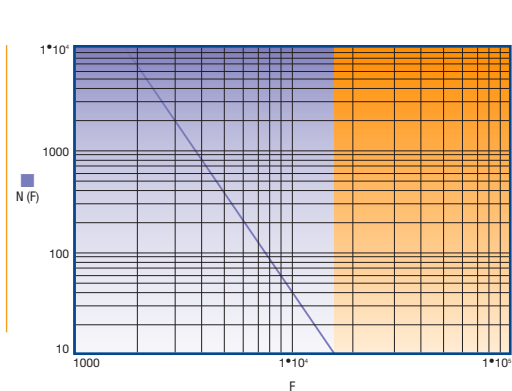
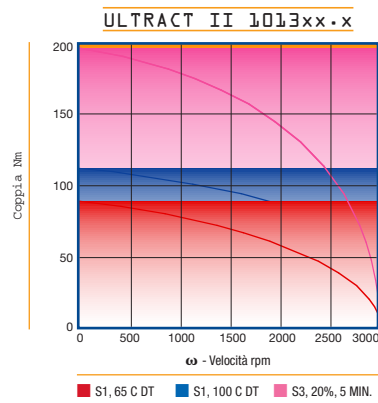
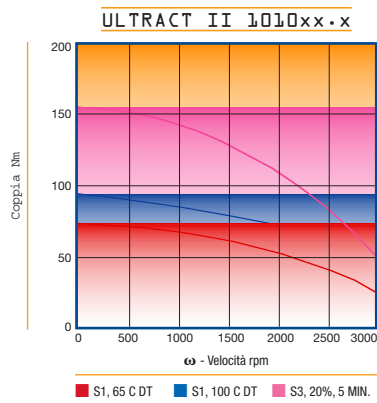
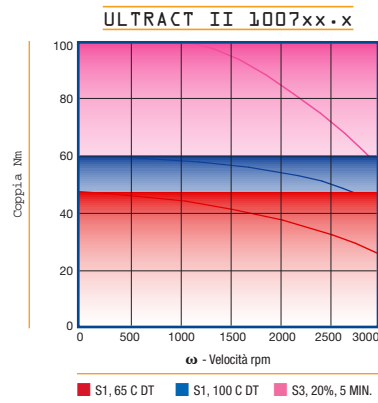
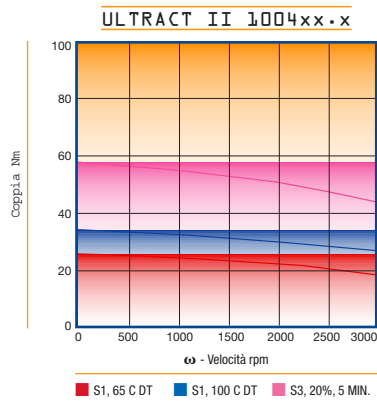

Vita (milioni di giri) dei cuscinetti in funzione del carico radiale (N) applicato alla mezziera della sporgenza d'albero del motore.
Bearing calculated lifetime (million of revs) versus radial load (N) applied in the middle of the shaft.

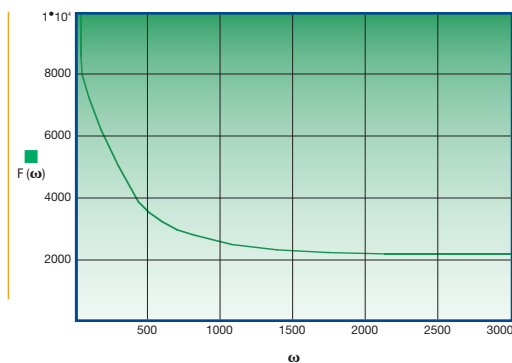

Massimo carico radiale (N) ammesso in funzione della velocità (rpm) per una vita di 30.000 ore.
Maximum radial load on shaft (N) versus speed (rpm) referred to 30.000 h bearing lifetime.