

版本 Rev No.	描述 Description	日期 Date	姓名 Name
B	Changed the power connector type.	08/10/11	Zhou Dan

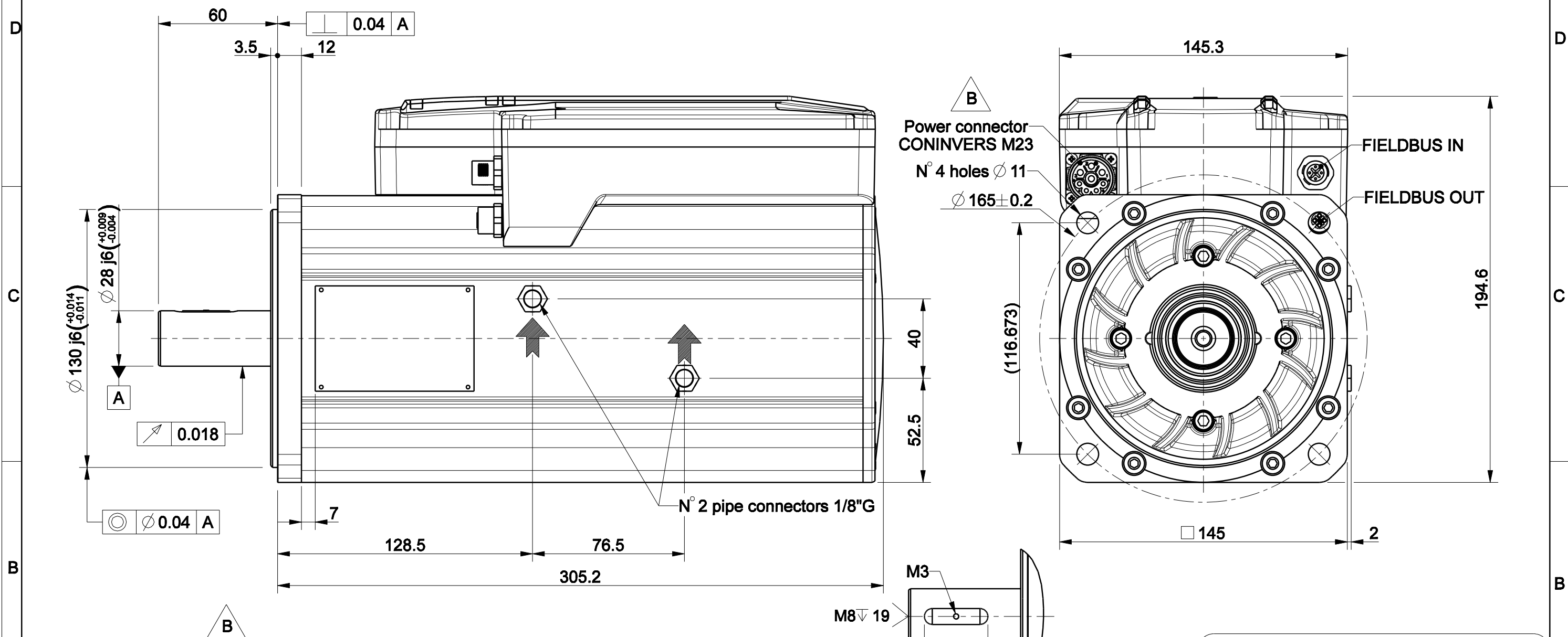

Pins	Description	PIN OUT	FIELDBUS - Connectors		EtherCAT Version M12 Codification D	
			Male	Female	IN Female	OUT Female
1	DC +	1	Shield	Shield	TX+	TX+
2	GND		Male	Female	IN Female	OUT Female
3	DC -	1	Shield	Shield	TX+	TX+
4	0V Supply	2	+24V Supply	+24V Supply	RX+	RX+
B	Aux in	3	CAN GND/0V Supply	CAN GND/0V Supply	TX-	TX-
C	+24V Supply	4	CAN-H	CAN-H	RX-	RX-
A	+24V Safe H	5	CAN-L	CAN-L	N.C.	N.C.
D	+24V Safe L					

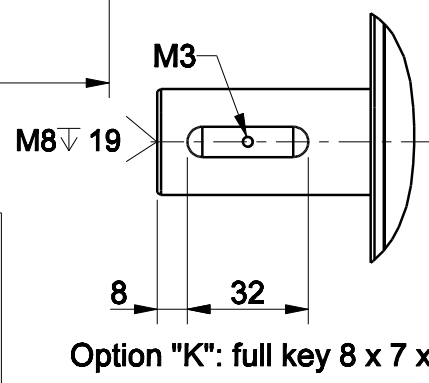

Approved

Signature	Date
-----------	------

材质 Material	处理 Treatment	项目 Project-Prod.item/Instrument	TW0720
几何公差 GB/T1184 (ISO 2768-2) Geometrical tolerance	未注公差 GB/T1804 (ISO 2768-2) Linear tolerance	描述 Description	MOTOR ASSEMBLY TW0720.40.4
角度公差 Angular tolerance	未注圆角 Undimensioned chamfers	电机总装	
0.5 +3	>3+ 6	未注圆角 Undimensioned radii	R0,5
±0.1	±0.1	图号 Drawing No.	50280N-0-B-3
年,月,日 Date	名字 Name	重量 Kg Mass	19.646
设计 Designed	25/12/09	数量 Qty	1/1
绘图 Drawn	08/10/11	页码 Sheet	1/1
校对 Checked			

